

**This electronic collection of documents is provided  
for the convenience of the user  
and is Not a Certified Document –**

**The documents contained herein were originally issued  
and sealed by the individuals whose names and license  
numbers appear on each page, on the dates appearing  
with their signature on that page.**

**This file or an individual page  
shall not be considered a certified document.**

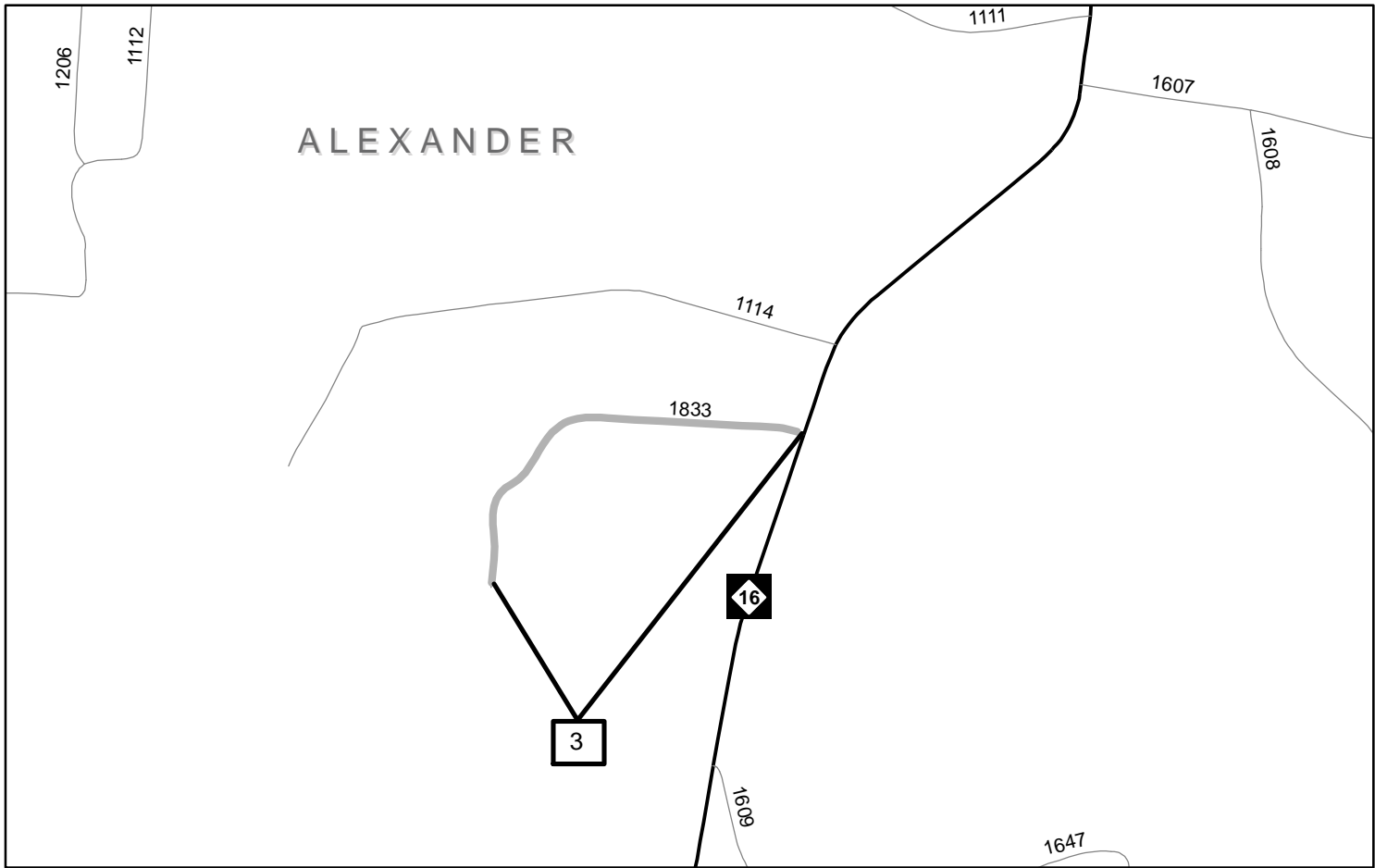

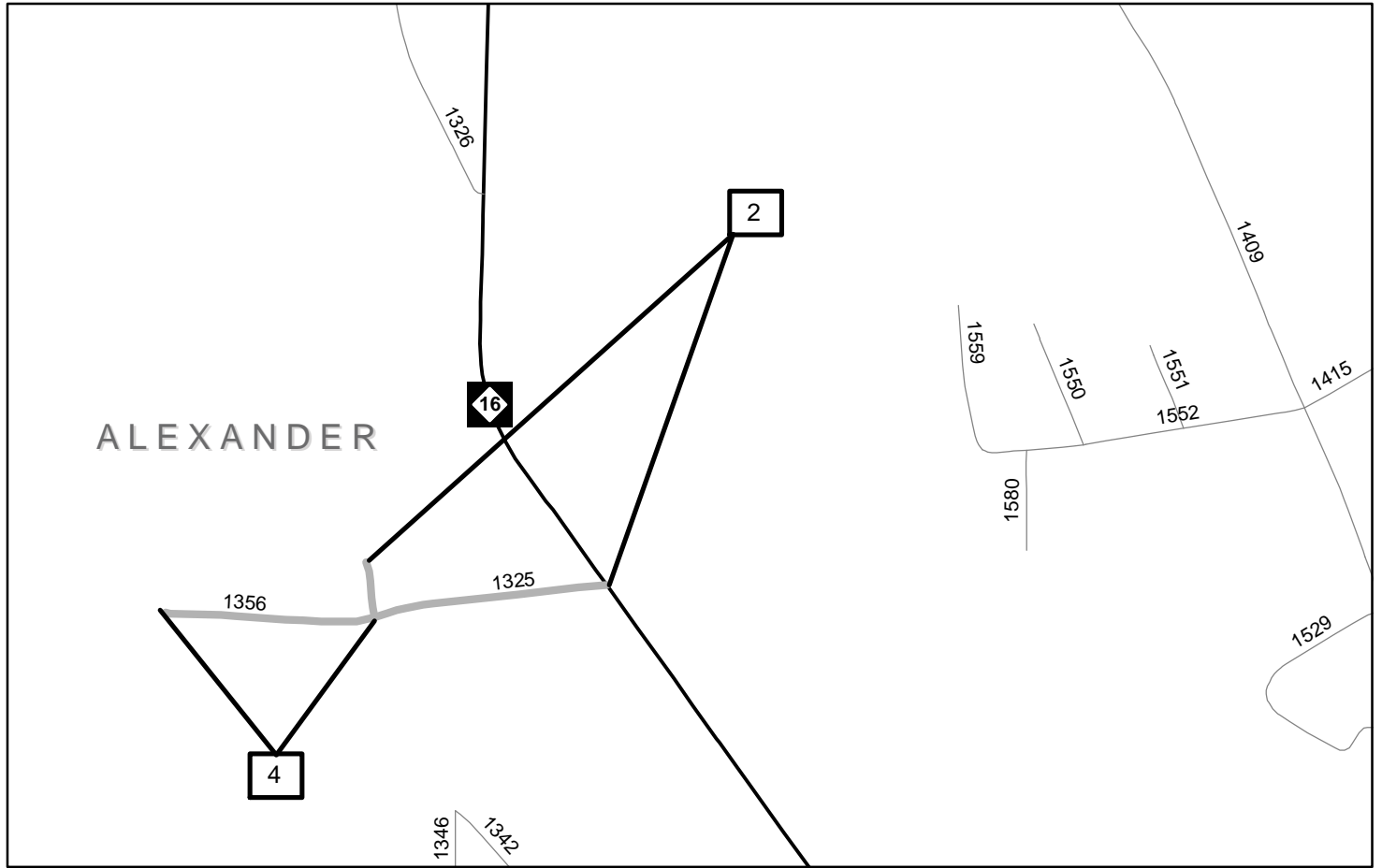
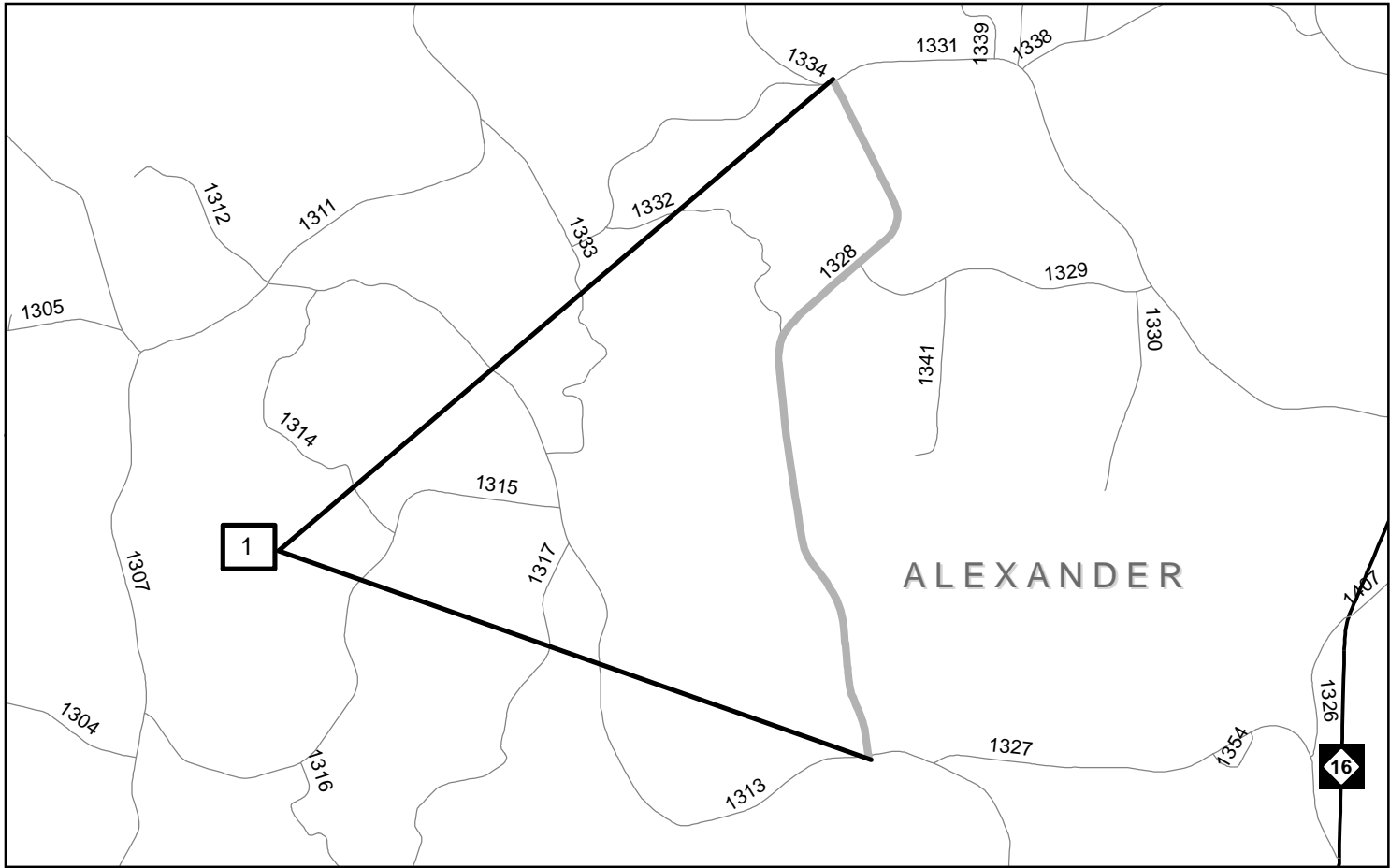
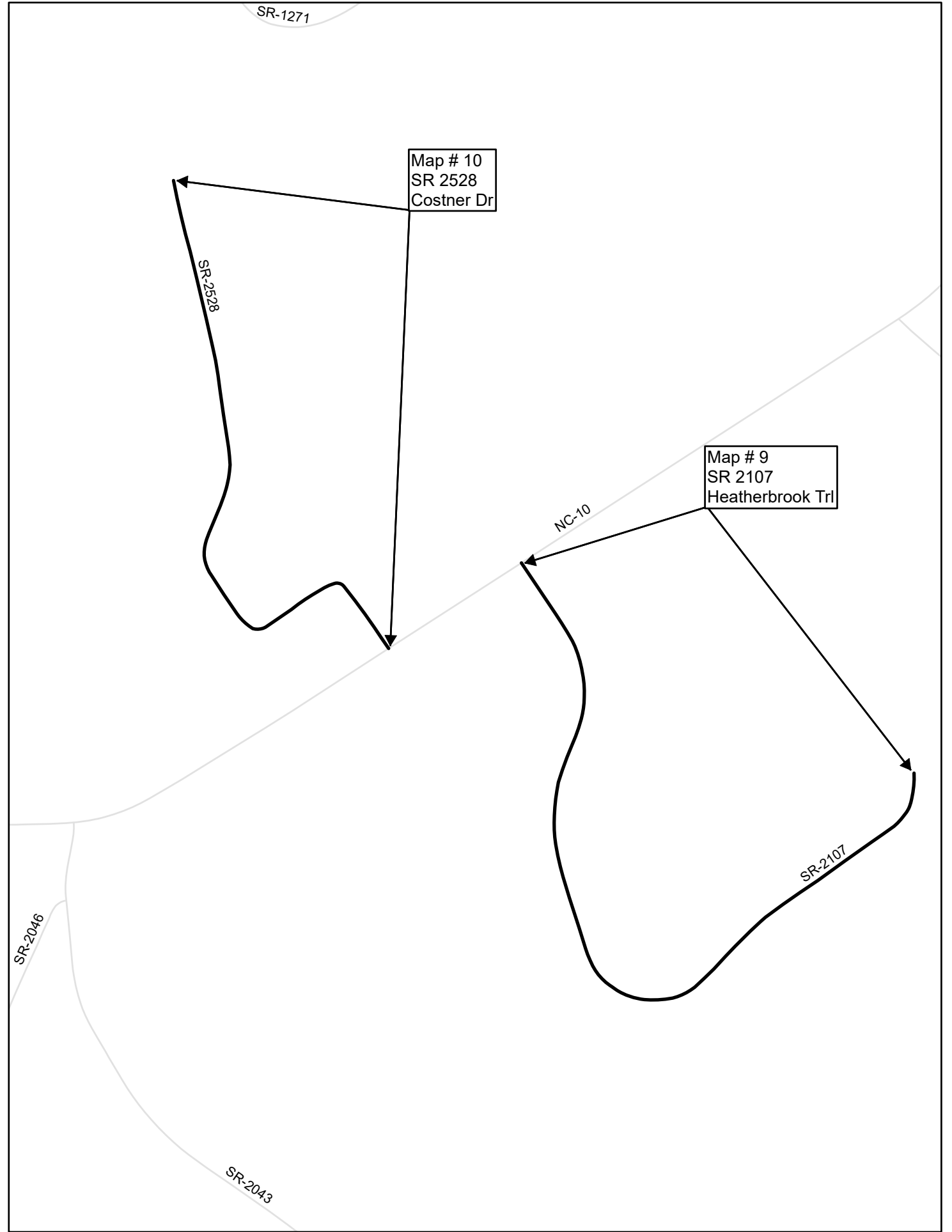
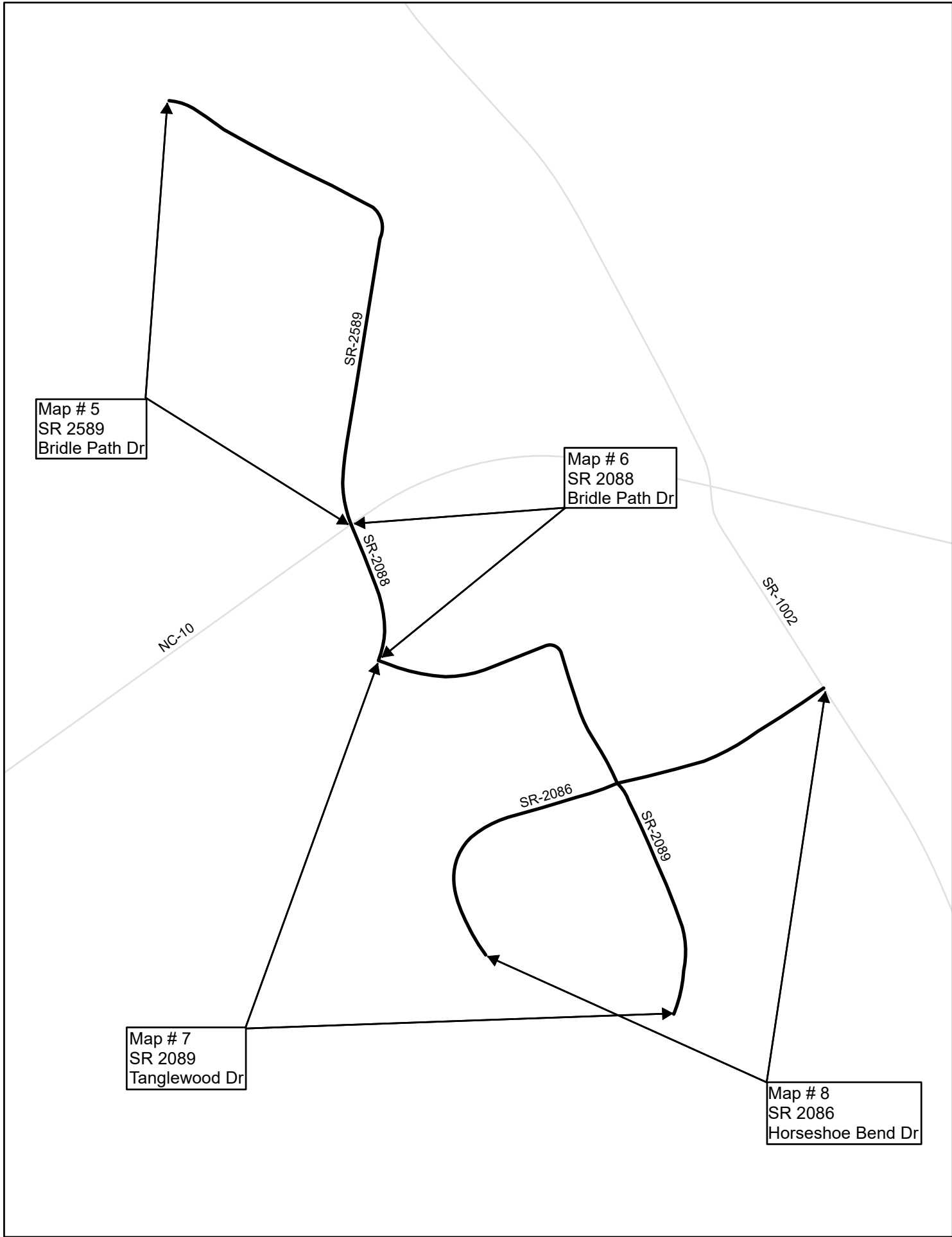

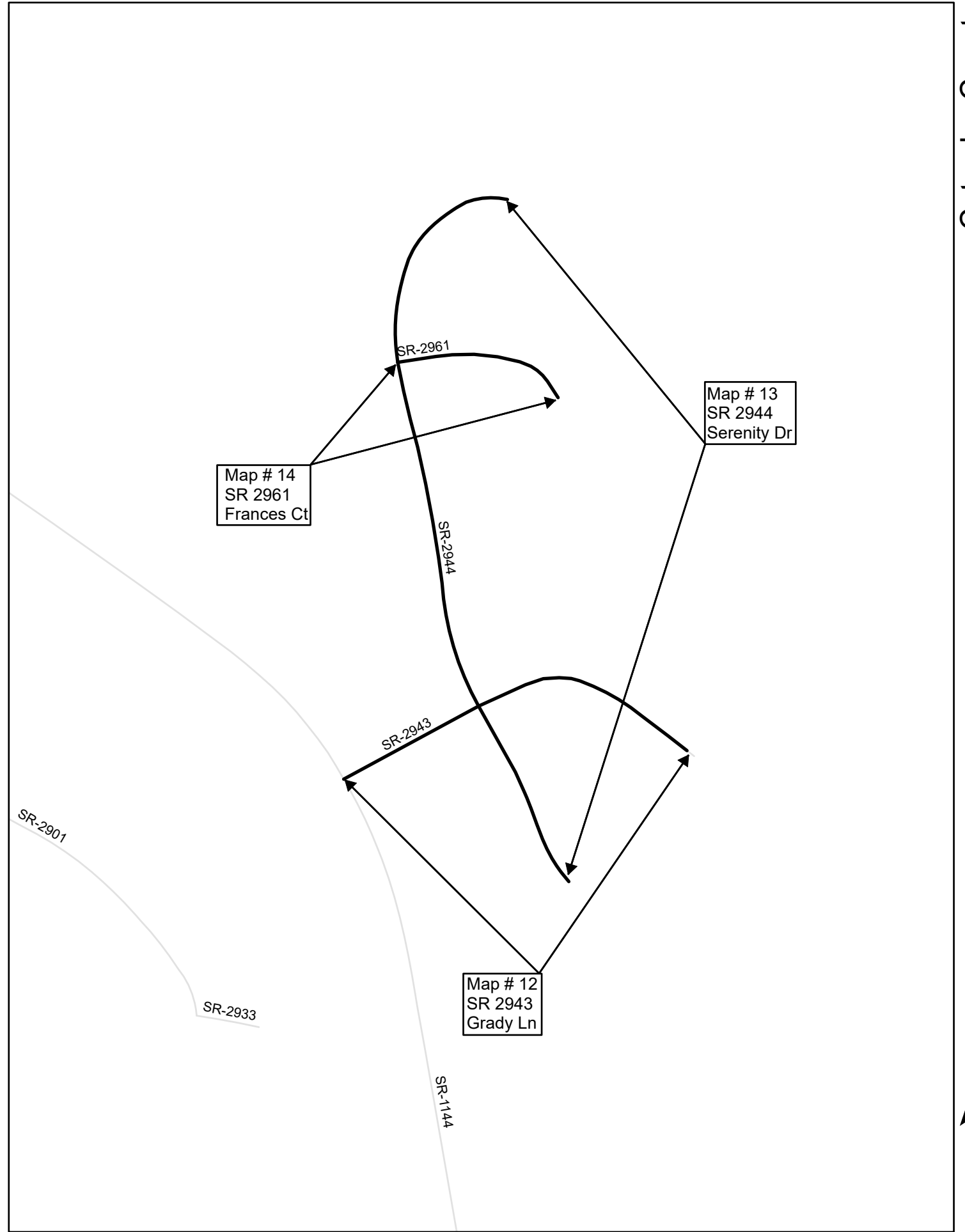
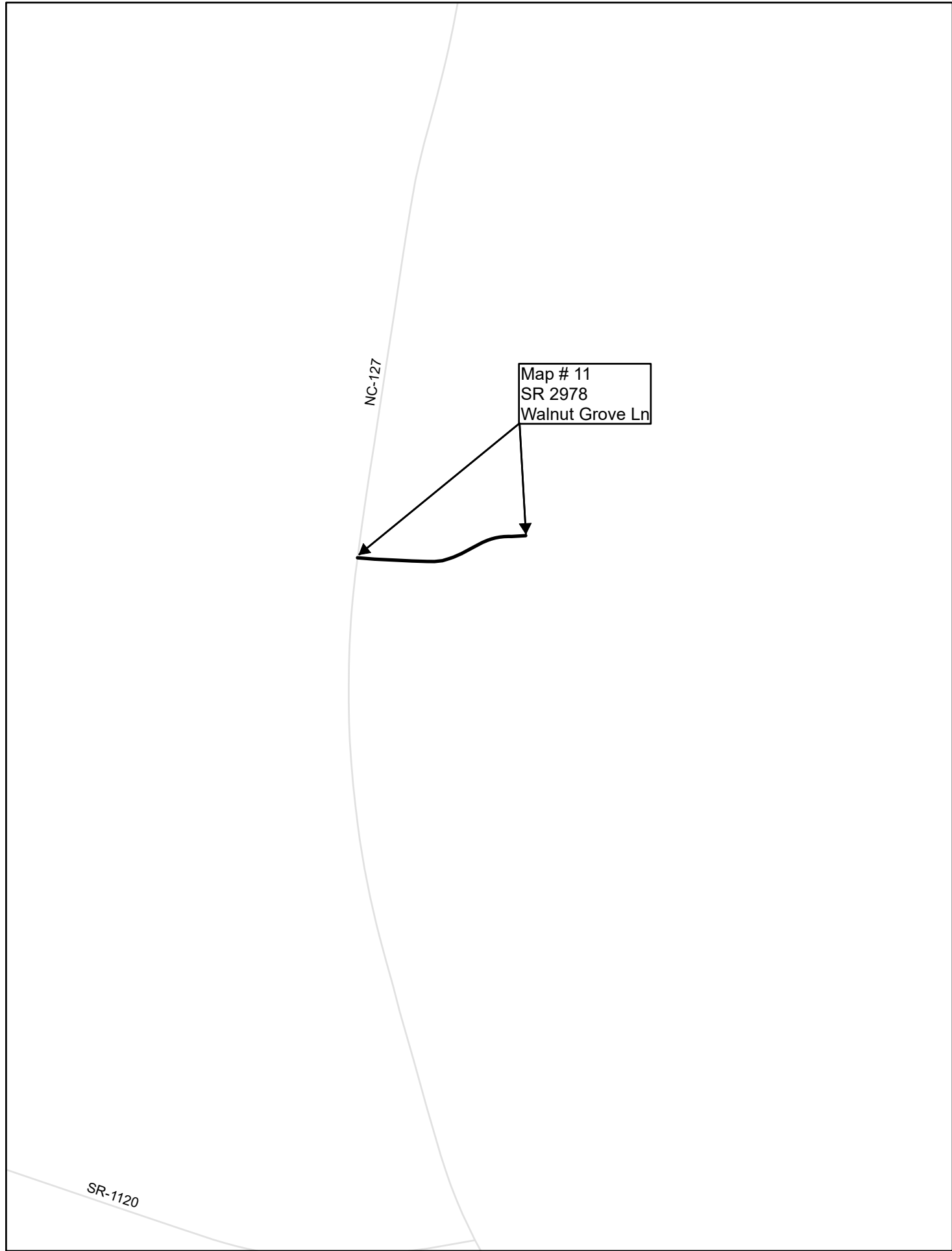

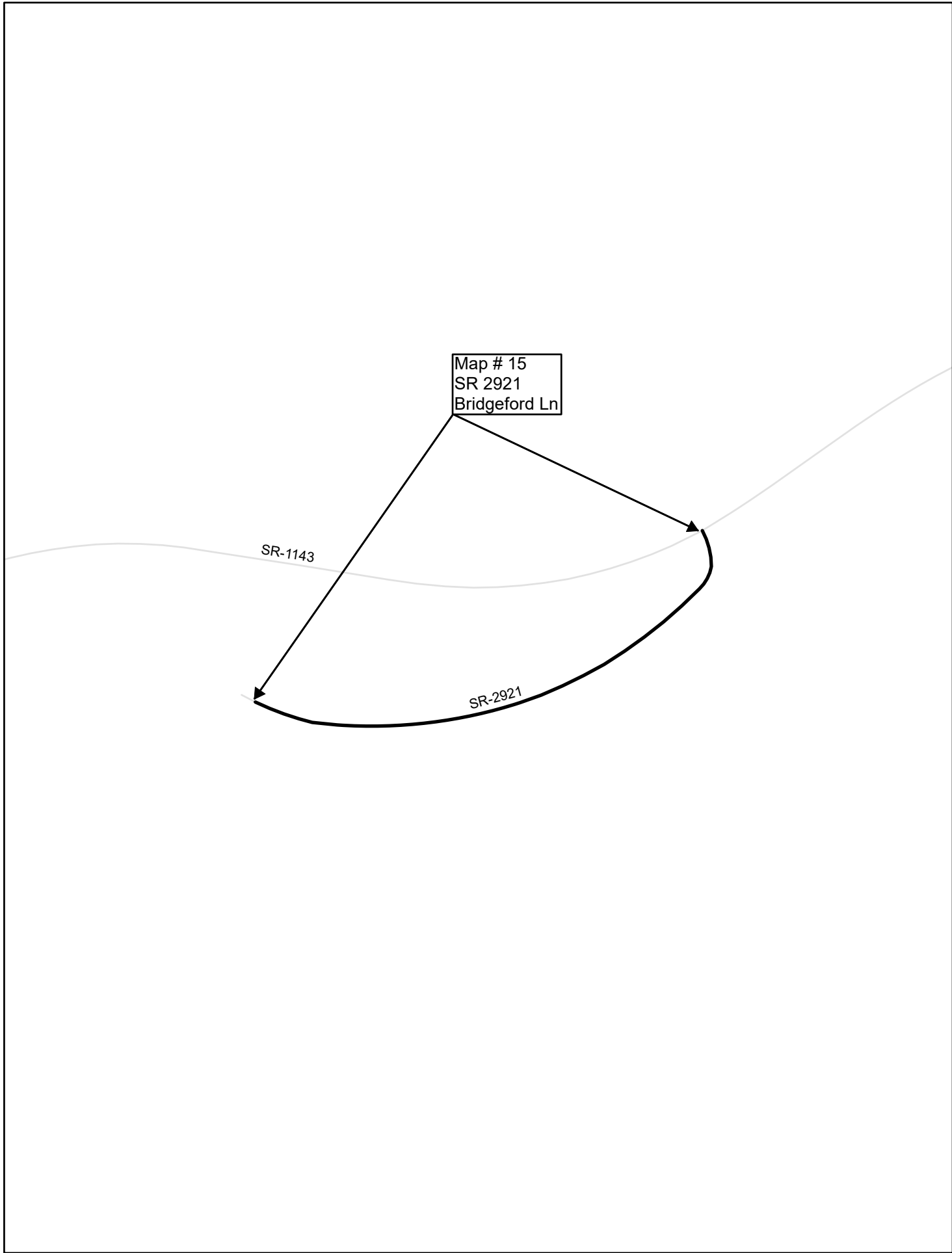

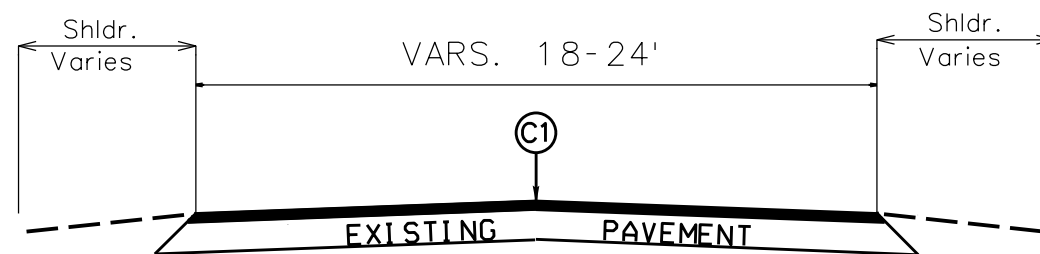

**TYPICAL SECTION NO. 1**

- Map 1 - Entire Map
- Map 2 - Entire Map
- Map 3 - Entire Map
- Map 4 - Entire Map
- Map 5 - Entire Map
- Map 6 - Entire Map
- Map 7 - Entire Map
- Map 8 - Entire Map
- Map 9 - Entire Map
- Map 10 - Entire Map
- Map 11 - Entire Map
- Map 12 - Entire Map
- Map 13 - Entire Map
- Map 14 - Entire Map
- Map 15 - Entire Map

| PAVEMENT SCHEDULE |   |
|-------------------|---|
| C1                | Prop. Approx. 1" Asphalt Concrete Surface Course, Type S9.5B, at an average rate of 110 LBS. Per Sq Yd. |

Checked by:

Drawn by: G. Brittain

**PARTIAL DEPTH PAVEMENT REPAIR DETAIL**

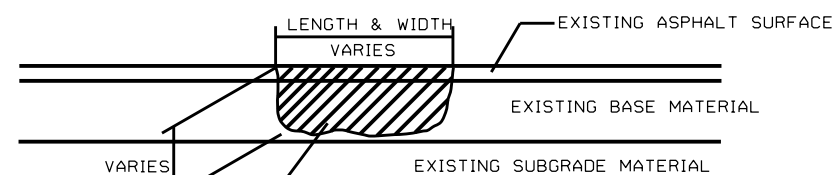

MILL EXISTING ASPHALT PAVEMENT AND REMOVE EXISTING LOOSE BASE AND/OR SUBGRADE MATERIAL AND REPLACE WITH ACIC TYPE, I19.0X AND ACSC TYPE, S9.5X AS DIRECTED BY THE ENGINEER.

**2026-2027  
PAVEMENT PRESERVATION  
ALEXANDER & CATAWBA  
COUNTIES**



|   |           |           |
|---|-----------|-----------|
| PROJECT NO.                                 | SHEET NO. | TOTAL NO. |
| 2026CPT.12.11.20022,<br>2026CPT.12.11.20182 | 8         | 10        |

## SUMMARY OF QUANTITIES

| PROJECT NO                                    | COUNTY    | MAP NO | ROUTE                          | DESCRIPTION  | TYP NO | LANES | LANE TYPE | LENGTH       | WIDTH | BEGI  | END   | 1220000000-E          | 1519000000-E          | 1575000000-E                 | 1880000000-E                  | 2845000000-N               |  |
|---|-----------|--------|--------------------------------|--|--------|-------|-----------|--------------|-------|-------|-------|-----------------------|-----------------------|------------------------------|-------------------------------|----------------------------|--|
|   |           |        |                                |  |        |       |           | MI           | FT    | N MP  | MP    | INCIDENTAL STONE BASE | SURFACE COURSE, S9.5B | ASPHALT BINDER FOR PLANT MIX | PARTIAL DEPTH PAVEMENT REPAIR | ADJ. OF METER OR VALVE BOX |  |
|   |           |        |                                |  |        |       |           | TONS         | TONS  | TONS  | TON   | EA                    |                       |                              |                               |                            |  |
| 2026CPT.12.11.20022                           | Alexander | 1      | SR-1328 / KIRBY LACKEY RD      | FROM SR 1313 (THREE FORKS CH RD) TO SR 1331 (LITTLE RIVER CH RD) | 1      | 2     |           | 2.425        | 19    | 0.000 | 2.425 | 5                     | 1,640                 | 107                          | 150                           |                            |  |
| 2026CPT.12.11.20022                           | Alexander | 2      | SR-1325 / EDD BURGESS RD       | FROM NC 16 TO END MAINTENANCE                                    | 1      | 2     |           | 0.256        | 19    | 0.000 | 0.256 | 3                     | 175                   | 11                           | 10                            | 1                          |  |
| 2026CPT.12.11.20022                           | Alexander | 3      | SR-1833 / KERDA ST             | FROM NC 16 TO END MAINTENANCE                                    | 1      | 2     |           | 0.556        | 19    | 0.000 | 0.556 | 5                     | 375                   | 24                           | 50                            |                            |  |
| 2026CPT.12.11.20022                           | Alexander | 4      | SR-1356 / EDD BURGESS ROAD EXT | FROM SR 1325 (EDD BURGESS RD) TO END MAINTENANCE                 | 1      | 2     |           | 0.184        | 19    | 0.000 | 0.184 | 5                     | 125                   | 8                            | 10                            |                            |  |
| <b>TOTAL FOR PROJ NO. 2026CPT.12.11.20022</b> |           |        |                                |  |        |       |           | <b>3.421</b> |       |       |       | <b>18</b>             | <b>2,315</b>          | <b>150</b>                   | <b>220</b>                    | <b>1</b>                   |  |
| 2026CPT.12.11.20182                           | Catawba   | 5      | SR-2589 / BRIDLE PATH DR       | FROM NC 10 TO CUL-DE-SAC   | 1      | 2     | 2WU       | 0.320        | 20    | 0.000 | 0.320 | 3                     | 297                   | 19                           | 20                            |                            |  |
| 2026CPT.12.11.20182                           | Catawba   | 6      | SR-2088 / BRIDLE PATH DR       | FROM NC 10 TO SR 2089 (TANGLEWOOD DR)                            | 1      | 2     | 2WU       | 0.080        | 20    | 0.000 | 0.080 |                       | 68                    | 4                            |                               |                            |  |
| 2026CPT.12.11.20182                           | Catawba   | 7      | SR-2089 / TANGLEWOOD DR        | FROM SR 2088 (BRIDLE PATH DR) TO CUL-DE-SAC                      | 1      | 2     | 2WU       | 0.340        | 21    | 0.000 | 0.340 | 10                    | 328                   | 21                           | 60                            |                            |  |
| 2026CPT.12.11.20182                           | Catawba   | 8      | SR-2086 / HORSESHOE BEND DR    | FROM SR 1002 (CAT SQUARE RD) TO CUL-DE-SAC                       | 1      | 2     | 2WU       | 0.300        | 22    | 0.000 | 0.300 | 15                    | 249                   | 16                           | 80                            |                            |  |
| 2026CPT.12.11.20182                           | Catawba   | 9      | SR-2107 / HEATHERBROOK TR      | FROM NC 10 TO CUL-DE-SAC   | 1      | 2     | 2WU       | 0.770        | 20    | 0.000 | 0.770 |                       | 548                   | 36                           | 20                            |                            |  |
| 2026CPT.12.11.20182                           | Catawba   | 10     | SR-2528 / COSTNER DR           | FROM NC 10 TO DEAD END   | 1      | 2     | 2WU       | 0.580        | 20    | 0.000 | 0.580 | 8                     | 395                   | 26                           | 20                            |                            |  |
| 2026CPT.12.11.20182                           | Catawba   | 11     | SR-2978 / WALNUT GROVE LN      | FROM NC 127 TO CUL-DE-SAC  | 1      | 2     | 2WU       | 0.129        | 20    | 0.000 | 0.129 | 2                     | 112                   | 7                            | 20                            |                            |  |
| 2026CPT.12.11.20182                           | Catawba   | 12     | SR-2943 / GRADY LN             | FROM SR 1144 (RIVER RD) TO CUL-DE-SAC                            | 1      | 2     | 2WU       | 0.170        | 19    | 0.000 | 0.170 |                       | 134                   | 9                            | 60                            |                            |  |
| 2026CPT.12.11.20182                           | Catawba   | 13     | SR-2944 / SERENITY DR          | FROM CUL-DE-SAC TO CUL-DE-SAC                                    | 1      | 2     | 2WU       | 0.340        | 19    | 0.000 | 0.340 |                       | 268                   | 17                           | 60                            |                            |  |
| 2026CPT.12.11.20182                           | Catawba   | 14     | SR-2961 / FRANCES CT           | FROM SR 2944 (SERENITY DR) TO CUL-DE-SAC                         | 1      | 2     | 2WU       | 0.080        | 19    | 0.000 | 0.080 |                       | 76                    | 5                            | 19                            |                            |  |
| 2026CPT.12.11.20182                           | Catawba   | 15     | SR-2921 / BRIDGEFORD LN        | FROM SR 1143 (SANDY FORD RD) TO DEAD END                         | 1      | 2     | 2WU       | 0.200        | 19    | 0.000 | 0.200 |                       | 129                   | 8                            | 40                            |                            |  |
| <b>TOTAL FOR PROJ NO. 2026CPT.12.11.20182</b> |           |        |                                |  |        |       |           | <b>3.309</b> |       |       |       | <b>38</b>             | <b>2,604</b>          | <b>168</b>                   | <b>399</b>                    |                            |  |
| <b>GRAND TOTAL</b>                            |           |        |                                |  |        |       |           | <b>6.730</b> |       |       |       | <b>56</b>             | <b>4,919</b>          | <b>318</b>                   | <b>619</b>                    | <b>1</b>                   |  |

|   |           |           |
|---|-----------|-----------|
| PROJECT NO.                                 | SHEET NO. | TOTAL NO. |
| 2026CPT.12.11.20022,<br>2026CPT.12.11.20182 | 9         | 10        |

## THERMOPLASTIC AND PAINT QUANTITIES

| PROJECT NO                                    | COUNTY    | MAP NO | ROUTE                          | DESCRIPTION   | TYP NO | LANES | LANE TYPE | LENGTH       | WIDTH | BEGIN MP | END MP | 4400000000-E                                       | 4457000000-N                    | 4810000000-E      | 4810000000-E       |
|---|-----------|--------|--------------------------------|---|--------|-------|-----------|--------------|-------|----------|--------|--|---------------------------------|-------------------|--------------------|
|   |           |        |                                |   |        |       |           | MI           | FT    |          |        | WORK ZONE<br>ADVANCE/GENERAL<br>WARNING<br>SIGNING | TEMPORARY<br>TRAFFIC<br>CONTROL | 4" WHITE<br>PAINT | 4" YELLOW<br>PAINT |
|   |           |        |                                |   |        |       |           |              |       |          |        | SF   | LS                              | LF                | LF                 |
| 2026CPT.12.11.20022                           | Alexander | 1      | SR-1328 / KIRBY LACKEY RD      | FROM SR 1313 (THREE FORKS CH RD)<br>TO SR 1331 (LITTLE RIVER CH RD) | 1      | 2     |           | 2.425        | 19    | 0        | 2.425  | 275  | *                               | 56,000            | 56,000             |
| 2026CPT.12.11.20022                           | Alexander | 2      | SR-1325 / EDD BURGESS RD       | FROM NC 16 TO END MAINTENANCE                                       | 1      | 2     |           | 0.256        | 19    | 0        | 0.256  | 30   | *                               |                   |                    |
| 2026CPT.12.11.20022                           | Alexander | 3      | SR-1833 / KERDA ST             | FROM NC 16 TO END MAINTENANCE                                       | 1      | 2     |           | 0.556        | 19    | 0        | 0.556  | 65   | *                               | 13,000            | 13,000             |
| 2026CPT.12.11.20022                           | Alexander | 4      | SR-1356 / EDD BURGESS ROAD EXT | FROM SR 1325 (EDD BURGESS RD)<br>TO END MAINTENANCE                 | 1      | 2     |           | 0.184        | 19    | 0        | 0.184  | 25   | *                               |                   |                    |
| <b>TOTAL FOR PROJ NO. 2026CPT.12.11.20022</b> |           |        |                                |   |        |       |           | <b>3.421</b> |       |          |        | <b>395</b>   |                                 | <b>69,000</b>     | <b>69,000</b>      |
| 2026CPT.12.11.20182                           | Catawba   | 5      | SR-2589 / BRIDLE PATH DR       | FROM NC 10 TO CUL-DE-SAC  | 1      | 2     | 2WU       | 0.32         | 20    | 0        | 0.32   | 48   | *                               |                   |                    |
| 2026CPT.12.11.20182                           | Catawba   | 6      | SR-2088 / BRIDLE PATH DR       | FROM NC 10 TO SR 2089<br>(TANGLEWOOD DR)                            | 1      | 2     | 2WU       | 0.08         | 20    | 0        | 0.08   |  | *                               |                   |                    |
| 2026CPT.12.11.20182                           | Catawba   | 7      | SR-2089 / TANGLEWOOD DR        | FROM SR 2088 (BRIDLE PATH DR) TO<br>CUL-DE-SAC                      | 1      | 2     | 2WU       | 0.34         | 21    | 0        | 0.34   |  | *                               |                   |                    |
| 2026CPT.12.11.20182                           | Catawba   | 8      | SR-2086 / HORSESHOE BEND DR    | FROM SR 1002 (CAT SQUARE RD) TO<br>CUL-DE-SAC                       | 1      | 2     | 2WU       | 0.3          | 22    | 0        | 0.3    | 48   | *                               |                   |                    |
| 2026CPT.12.11.20182                           | Catawba   | 9      | SR-2107 / HEATHERBROOK TR      | FROM NC 10 TO CUL-DE-SAC  | 1      | 2     | 2WU       | 0.77         | 20    | 0        | 0.77   | 24   | *                               |                   |                    |
| 2026CPT.12.11.20182                           | Catawba   | 10     | SR-2528 / COSTNER DR           | FROM NC 10 TO DEAD END  | 1      | 2     | 2WU       | 0.58         | 20    | 0        | 0.58   | 24   | *                               |                   |                    |
| 2026CPT.12.11.20182                           | Catawba   | 11     | SR-2978 / WALNUT GROVE LN      | FROM NC 127 TO CUL-DE-SAC   | 1      | 2     | 2WU       | 0.129        | 20    | 0        | 0.129  | 48   | *                               |                   |                    |
| 2026CPT.12.11.20182                           | Catawba   | 12     | SR-2943 / GRADY LN             | FROM SR 1144 (RIVER RD) TO CUL-DE-<br>SAC                           | 1      | 2     | 2WU       | 0.17         | 19    | 0        | 0.17   | 48   | *                               |                   |                    |
| 2026CPT.12.11.20182                           | Catawba   | 13     | SR-2944 / SERENITY DR          | FROM CUL-DE-SAC TO CUL-DE-SAC                                       | 1      | 2     | 2WU       | 0.34         | 19    | 0        | 0.34   |  | *                               |                   |                    |
| 2026CPT.12.11.20182                           | Catawba   | 14     | SR-2961 / FRANCES CT           | FROM SR 2944 (SERENITY DR) TO CUL-<br>DE-SAC                        | 1      | 2     | 2WU       | 0.08         | 19    | 0        | 0.08   |  | *                               |                   |                    |
| 2026CPT.12.11.20182                           | Catawba   | 15     | SR-2921 / BRIDGEFORD LN        | FROM SR 1143 (SANDY FORD RD) TO<br>DEAD END                         | 1      | 2     | 2WU       | 0.2          | 19    | 0        | 0.2    | 48   | *                               |                   |                    |
| <b>TOTAL FOR PROJ NO. 2026CPT.12.11.20182</b> |           |        |                                |   |        |       |           | <b>3.309</b> |       |          |        | <b>288</b>   |                                 |                   |                    |
| <b>GRAND TOTAL</b>                            |           |        |                                |   |        |       |           | <b>6.73</b>  |       |          |        | <b>683</b>   | <b>1</b>                        | <b>69,000</b>     | <b>69,000</b>      |

# SIGNING FOR RESURFACING PROJECTS

**LEGEND**  
 ┆ STATIONARY SIGN  
 ← DIRECTION OF TRAFFIC FLOW

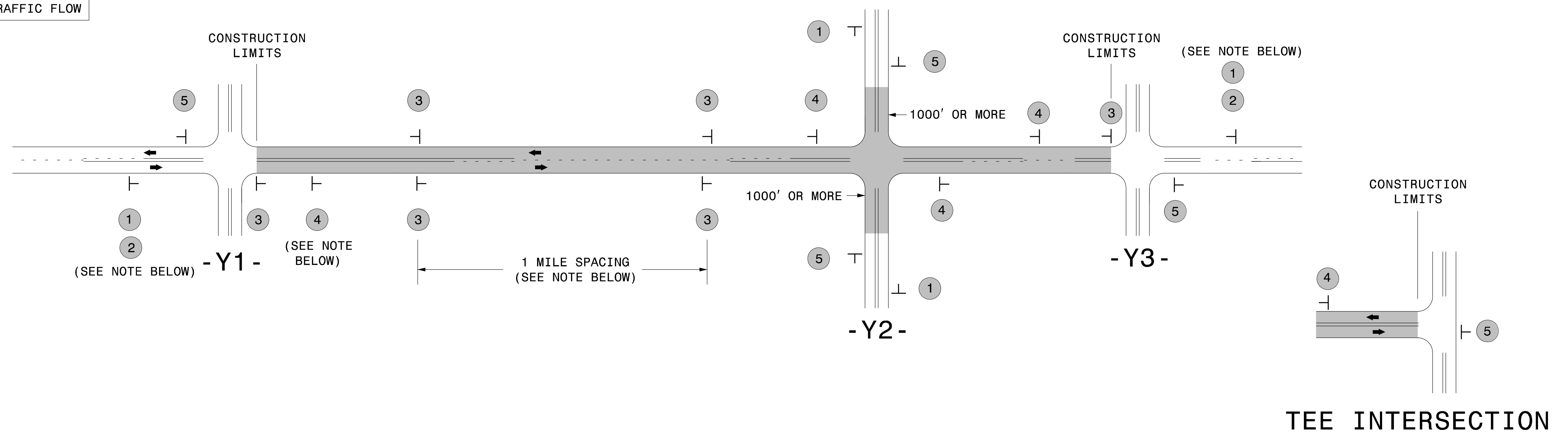

## MAINLINE (-L-) SIGNING

## -Y- LINE SIGNING

|   |   |  |   |   |
|---|---|--|---|---|
| SIGNING NOTES AND PLACEMENT PER DIRECTION | 1 |  | PLACE 1000' PRIOR TO BEGINNING OF CONSTRUCTION LIMITS. ONLY USED ON -Y- LINES IF RESURFACING LIMITS EXTEND 1000' ALONG -Y- LINE.  | <p>NO REQUIRED STATIONARY SIGNING FOR THE FOLLOWING -Y- LINE CONDITIONS:</p> <ol style="list-style-type: none"> <li>1) LESS THAN 1000' OF RESURFACING ALONG -Y- LINE</li> <li>2) SUBDIVISION ROADS</li> <li>3) DEAD END ROADS</li> </ol> <p>WHEN PAVING/CONSTRUCTION ACTIVITIES PROCEED ACROSS AN UNSIGNED -Y- LINE, PORTABLE ADVANCE WARNING SIGNS SHALL BE USED ALONG THE -Y- LINE AS SHOWN BELOW. REMOVE UPON COMPLETION OF WORK.</p> <div style="display: flex; justify-content: space-around;"> <div style="text-align: center;"> <br/>           W20-1<br/>48" X 48"<br/>           PLACED 500' IN ADVANCE OF FLAGGER.         </div> <div style="text-align: center;"> <br/>           W20-7 A<br/>48" X 48"<br/>           PLACED 250' IN ADVANCE OF FLAGGER.         </div> </div> |
|   | 2 |  | #2 SIGN ONLY USED WHEN CONSTRUCTION LIMITS ARE 2 OR MORE MILES IN LENGTH. ROUND UP TO NEXT WHOLE NUMBER. (NO FRACTIONAL OR DECIMAL NUMBERS)   |   |
|   | 3 |  | - PLACE INITIALLY AT THE CONSTRUCTION LIMITS AND SPACE 1 MILE APART THEREAFTER.<br>- AT TEE INTERSECTIONS INSTALL INITIALLY 1/2 MILE FROM INTERSECTION AND SPACE 1 MILE APART THEREAFTER.   |   |
|   | 4 |  | - THESE ARE FOR -Y- LINES THAT ARE "THROUGH" ROADWAYS.<br>- DEAD END AND SUBDIVISION ROADS ARE NOT "THROUGH" ROADWAYS.<br>- INSTALL 500' +/- FROM EACH -Y- LINE APPROACH AS SHOWN ABOVE.<br>- FOR MULTIPLE -Y- LINES THAT ARE SEPARATED BY 0.25 MILES OR LESS, TREAT AS A SINGLE UNIT AND INSTALL WITHIN 500' OF EACH APPROACH.<br>- A MAXIMUM OF 2 SIGN SETS PER MILE. DO NOT INSTALL WHEN -Y- LINES ARE WITHIN 0.5 MILES FROM "END ROAD WORK" SIGN.<br>- FOR TEE INTERSECTIONS, INSTALL WITHIN 500' +/- OF THE INTERSECTION ALONG -L- LINE. |   |
|   | 5 |  | PLACE 500' FOLLOWING THE END OF CONSTRUCTION LIMITS OR AS SHOWN WHEN WORK ENDS AT A 3-WAY TEE INTERSECTION.   |   |

THE ABOVE SIGNS ARE ALL THAT ARE REQUIRED FOR A CONTRACTOR TO BEGIN A RESURFACING CONTRACT. ANY ADDITIONAL SIGNS REQUESTED BY NCDOT DIVISIONS SHALL BE INSTALLED WITHIN 7 BUSINESS DAYS OF THE START OF CONTRACT WORK.

**MAPS LESS THAN 2 MILES**

FOR RESURFACING MAPS WITH CONSTRUCTION LIMITS LESS THAN 2 MILES IN LENGTH, NO STATIONARY SIGNS ARE REQUIRED. USE PORTABLE "ROAD UNDER CONSTRUCTION" OR "ROAD WORK AHEAD" SIGNS IN LIEU OF STATIONARY ADVANCE WARNINGS SIGNS.

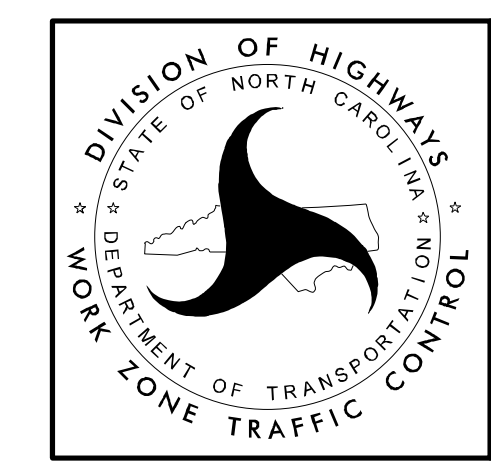

**ADVANCE WARNING SIGNS FOR RURAL AND SUBURBAN 2-LANE ROADWAY RESURFACING**

5/15/2017 S:\TUXWZTC\Resurfacing\2L2W & AST Resurfacing Details\Resurfacing\_AdvWarn\_2Ln.dgn User:kadai